

Series 25

Direct Mount 2-Piece

Full Port Ball Valve

1/4" – 3" (DN8 – DN80)

1000 psi (PN64)

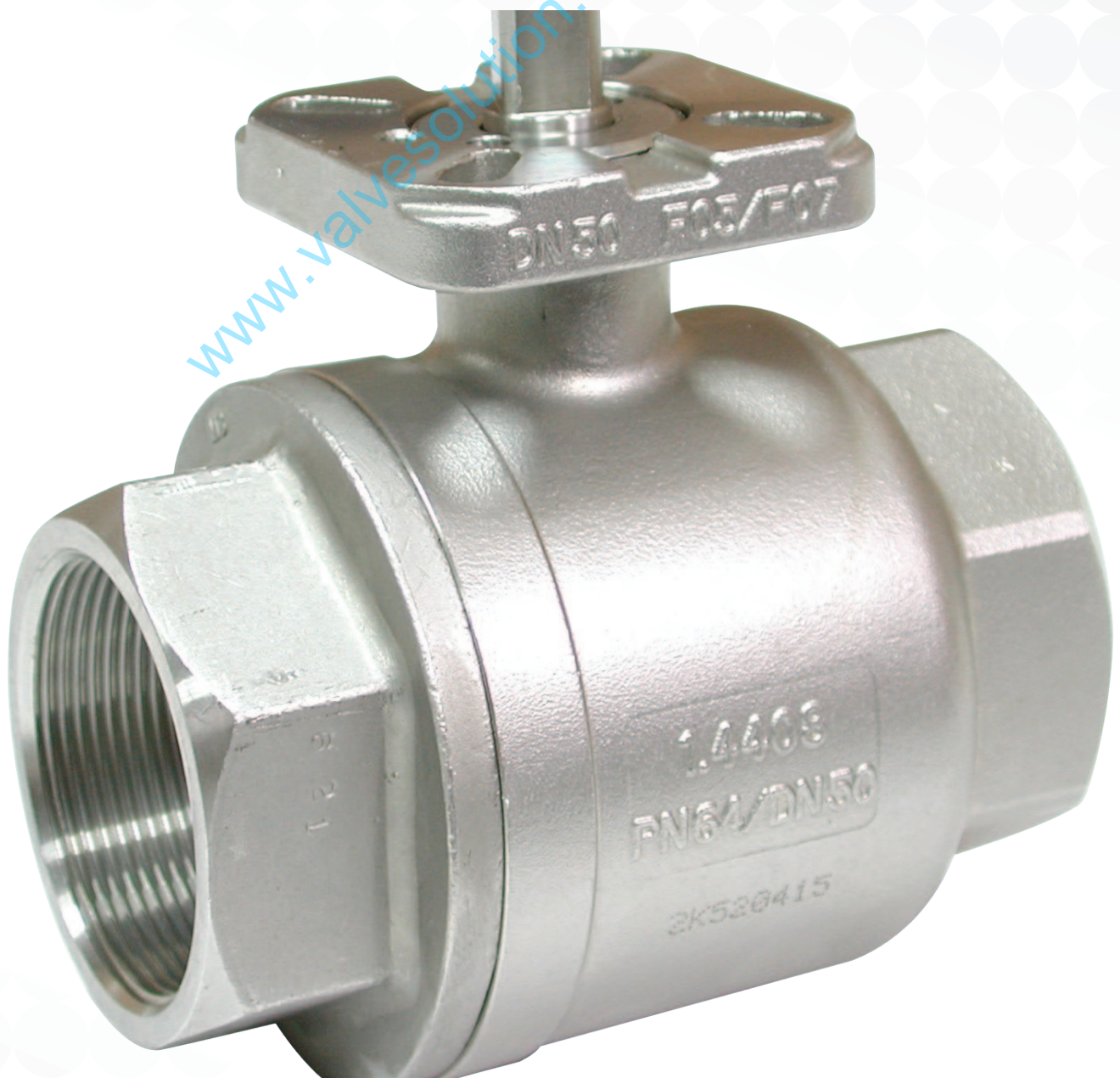

Ball Valve Feature Direct Mount

DIE ERSTE Series 25 ball valves feature direct mounting pad, exclusive stem design, and other unique supporting parts to meet customer's requirement. The direct mounting pad is constructed with two patterns, which in comply with the ISO 5211 standard.

The exclusive stem design makes Series 25 ball valves more competitive. The self-adjusting stem packing design with Belleville springs can prevent temperature fluctuation and valve vibration, and thus, creates a secure valve use. The stem seal are specially designed to be 45-degree against the valve body, which increases the effectiveness of the valve. In addition, stems are modeled to be blowout-proof, with the upside down insertion.

Series 25 ball valves also come with various parts. DIE ERSTE provides a wide ranges seat and seal with various material to choose from. All of our valve bodies are investment casting with retraceable furnace number, and also solution annealed for highest quality and strength. The ball designs of the Series 25 valves are floating-ball method; the valve ball is floating inside the valve body, and lean towards the downstream flow direction. The result presents a strong sealing effect under both low and high pressures.

Other features include API 598 testing and inspection regulations, in which every valve will undergo a series of inspections by our quality assurance engineer to achieve the highest conformity rate.

Valve Body Rating with Seat Material Plot:

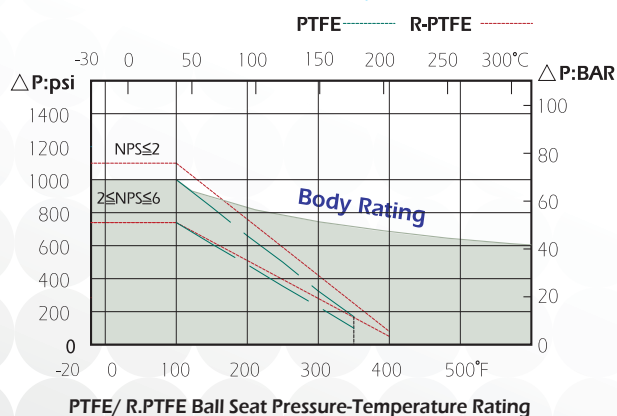

CE marking 0035

The whole series of ball valves are approved according to European Directive 97/23/EC.

Direct Mounting Pad

The Series 25 ball valves are constructed with twin ISO 5211-complied mounting pads, which provide possibilities of actuators.

Stem Packing Design

The self-adjusting stem packing design will avoid temperature fluctuation and valve vibrations. This design also includes blowout-proof stem design.

Comprehensive Parts Supply

DIE ERSTE Series 25 ball valves come with different type of material for seal and seat to meet our customer's specification.

Pressure Rating

1000 psi (PN64) WOG

150 psi (10 bar) with saturated steam

Temperature Range:

-20°F to 400°F (-28°C to 204°C) with PTFE/RPTFE

End Connection:

Threaded

Butt-welding

Socket-welding

Body Material:

ASTM CF8M, CF8, WCB

(DIN 1.4408, 1.4308, 1.0619)

Size Range:

1/4"~3" (DN8~DN80)

Standards and Specifications

Female Thread end-to-end length meets

NPT, DIN 259/2999, and BS21

Valve body and end cap connections are high quality investment cast. Both stainless steel material and carbon steel are solution annealed and normalized to ensure the highest quality. Body and end cap are designed according to ASME B16.34 regulation.

Valve stems are blow-out proof for maximum safety, and meet ASME/ANSI B16.34 specifications.

All valves are factory tested to API 598 and MSS SP-72.

Series 25 2pc Ball Valve

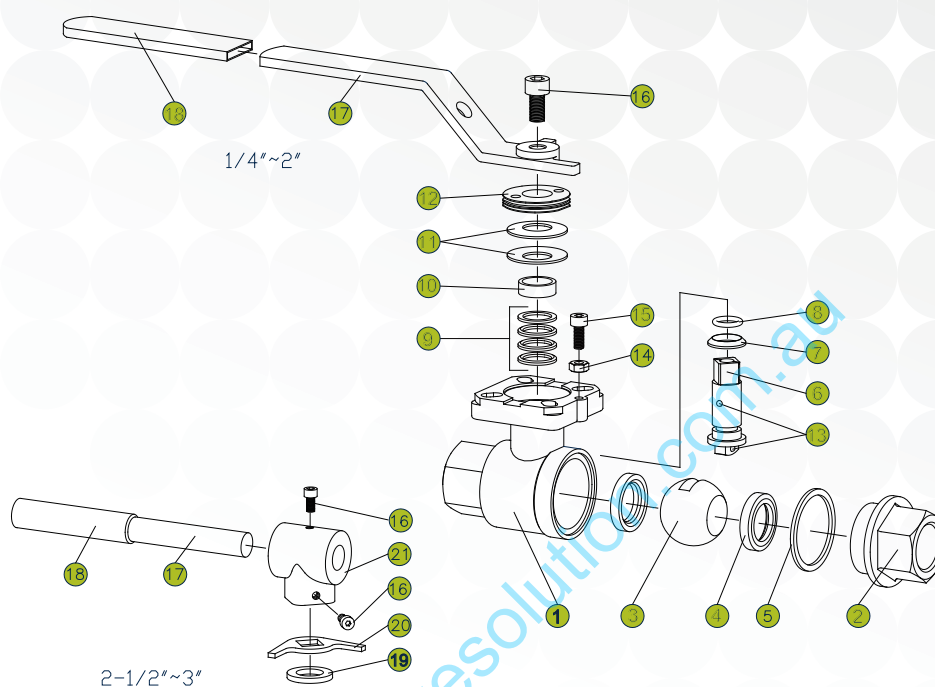

NO	PART NAME	MATERIAL
1	BODY	ASTM A351 CF8M
2	END CAP	ASTM A351 CF8M
3	SOLID BALL	ASTM A351 CF8M
4	BALL SEAT	PTFE
5	BODY SEAL	PTFE
6	STEM	SS316
7	THRUST WASHER	PTFE
8	O-RING	VITON
9	STEM PACKING	PTFE
10	FOLLOWER	SS304
11	BELLEVILLE SPRING	SS304

NO	PART NAME	MATERIAL
12	NUT	SS304
13	ANTI-STATIC DEVICE	SS316
14	STOP NUT	SS304
15	STOP BOLT	SS304
16	HANDLE BOLT	SS304
17	HANDLE	SS304
18	HANDLE SLEEVE	VINYL
19	HANDLE SPACER	PTFE
20	TRIANGLE STOPPER	SS304
21	LOCKING DEVICE	SS304

Dimensions **inch/mm**

SIZE Inch DN	D	L	H1	H	S	Cv Kv	Weight (kg)	TQ in-lbs/ NM	ISO 5211
1/4" 8	0.45 11.5	2.56 65	0.3 7.5	1.7 43	0.35 9	8 6.84	0.4	45/5	F03/F04
3/8" 10	0.5 12.7	2.56 65	0.3 7.5	1.7 43	0.35 9	10 8.55	0.4	45/5	F03/F04
1/2" 15	0.59 15	3 75	0.3 7.5	1.7 43	0.35 9	13 11.1	0.48	60/7	F03/F04
3/4" 20	0.78 20	3.15 80	0.31 8	1.77 45	0.35 9	50 42.7	0.56	80/9	F03/F04
1" 25	1 25	3.54 90	0.43 11	2.1 53	0.43 11	93 79.5	0.75	130/15	F04/F05
1 1/4" 32	1.26 32	4.3 110	0.43 11	2.24 57	0.43 11	170 145.3	1.48	160/18	F04/F05
1 1/2" 40	1.57 40	4.72 120	0.5 14	2.67 68	0.55 14	250 213.7	2.32	200/23	F05/F07
2" 50	2 50	5.5 140	0.5 14	3 77	0.55 14	450 384.6	3.8	280/32	F05/F07
2 1/2" 65	2.5 65	7.3 185	0.67 17	3.9 99	0.67 17	750 641	8	500/57	F07/F10
3" 80	3.15 80	8.1 205	0.67 17	4.4 111	0.67 17	1300 1111.1	11.5	650/73	F07/F10

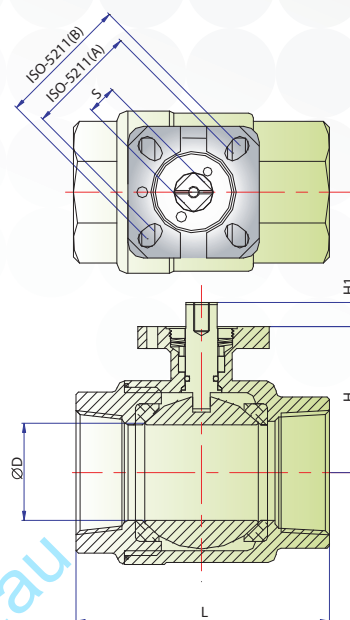

Optional Accessories

Automation Products

With the direct mount design, the Series 25 ball valves can be combined with every DIE ERSTE automatic control products without any troubles. Currently, DIE ERSTE offers two pneumatic actuator (Rack & Pinion type and Vane type) and Jexme electric actuator to accompany the Series 25 ball valves.

Various Handle Choices

For the Series 25 ball valves, DIE ERSTE offers two types of handle options: original lever handle and oval handle. The lever handle with the vinyl sleeves is the standard equipment that is widely used. The vinyl can be customized to be different colors, words, and even simple graphics. The oval handle is used when the standard lever handle can be turned accidentally. The oval handle also allows user to identify the valve position. It also slows down the valve closing speed, which decrease the chances of water hammer on liquid.



How to order

[illegible]